

## 42nd Sydney Basin Symposium

Understanding the Sydney Basin Today is the key to Tomorrow's Sustainability

### Welcome Networking

Tuesday 20th August 2024  
6:30pm - 10:30pm

### Sydney Basin Symposium

Wednesday - Thursday, 21st - 22nd August 2024  
9:00am - 5:00pm

### Scientific Program

There are a range of general topics that will be covered, including:

- Coal Geology
- Coal Quality
- Mine Geology
- Exploration
- Geochronology
- Igneous Geology
- Structural and Geotechnical Geology
- State of the Industry
- Environmental and Social
- Hydrogeology
- Gas and Petroleum Geology
- Geophysics

### Registration Options and Pricing: Symposium - 21st August - 22nd August 2024

#### Welcome Networking - 20th August 2024

Networking cost per person \$40  
Queens Wharf Brewery

#### Dinner - Wednesday 21st August 2024

Dinner cost per person \$150  
(Guests of conference delegates are welcome)

#### Delegate Registration

2 Day Delegate Registration incl dinner \$450  
1 Day Delegate Registration \$150

#### Student Pricing

2 Day Registration \$100  
1 Day Registration \$50

Student Dinner \$70

Student Networking \$20

#### Field Trip - 23rd August 2024

Newcastle Geotrail \$TBA

**Registrations close 5:00pm Friday 19th July, 2024. Registration link below.**

<https://www.eventbrite.com.au/e/42nd-sydney-basin-symposium-2024-tickets-838333476997?aff=oddttdcreator>

### Venue

Newcastle City Hall  
290 King Street  
Newcastle NSW 2300  
Australia  
Phone: (02) 4974 2166



Newcastle  
City Hall

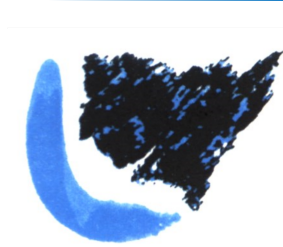
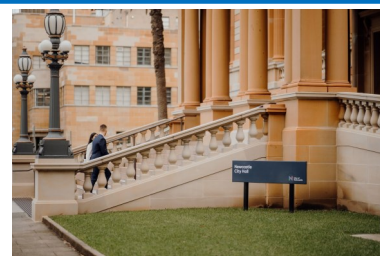

Coalfield Geology Council  
of New South Wales

# Sponsorship and Exhibition

## Sydney Basin Symposium

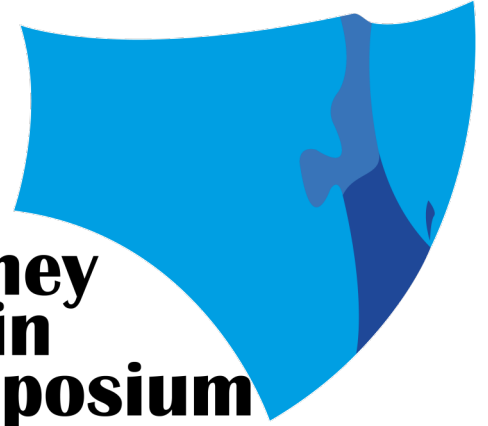

### Sponsorship and Exhibition

The SBS Committee is now taking bookings for sponsorship including exhibition booth spaces from interested exhibitors.

Please register your interest via:

[sponsorship@sydneybasinsymposium.net](mailto:sponsorship@sydneybasinsymposium.net).

A tax invoice will be issued and sponsorship 'confirmed' upon receipt of payment and a company logo for use in advertising material.

Sponsorship closing dates -

- Booth registrations must be completed prior to Wednesday 31st July to allow printing of signage.

### Booth Details

The booths are standard exhibition booths with black carpet feel walls. Panels are constructed from fibrous cement sheeting, and are supported with aluminium profiles. Posters and lightweight signage may be attached to the panels using hook Velcro dots.

Each booth consists of the following:

- 2.5m high walls (size options - see plan)
- 1 x company signage fascia (32 characters maximum)
- 1 x exhibitor spotlight
- 1 x 10 Amp general purpose outlet
- (Flexibility available)

Tables and chairs are supplied as per plan, if you wish to change this setup please contact our exhibition display provider who is able to offer a full support service to all exhibitors requiring furniture, signage, AV or plant hire. Additional equipment can be ordered by contacting Marlin Exhibitions by email [marlin-hire@gmail.com](mailto:marlin-hire@gmail.com) or phone 0434 153 635. Copies of equipment and furniture hire catalogue are available on the website [www.marlinexhibitions.com.au](http://www.marlinexhibitions.com.au).

Furniture and accessories are the exhibitor's responsibility.

### Exhibition Program

#### Tuesday 20th August

12:00pm - 6:00pm: Marlin Bump-in

4:00pm - 6:00pm: Exhibitor Bump-in

#### Wednesday/Thursday 21/22nd August

9:00am - 5:00pm: Full day delegate access

Close of day 22/8: Marlin Bump Out from 4:00pm

### Costs

Multiple sponsors are welcome. All sponsorship will include company logo on program and during conference proceedings, and advertising material (as supplied by the sponsor) including signage at the venue.





# Cummings Room Booths

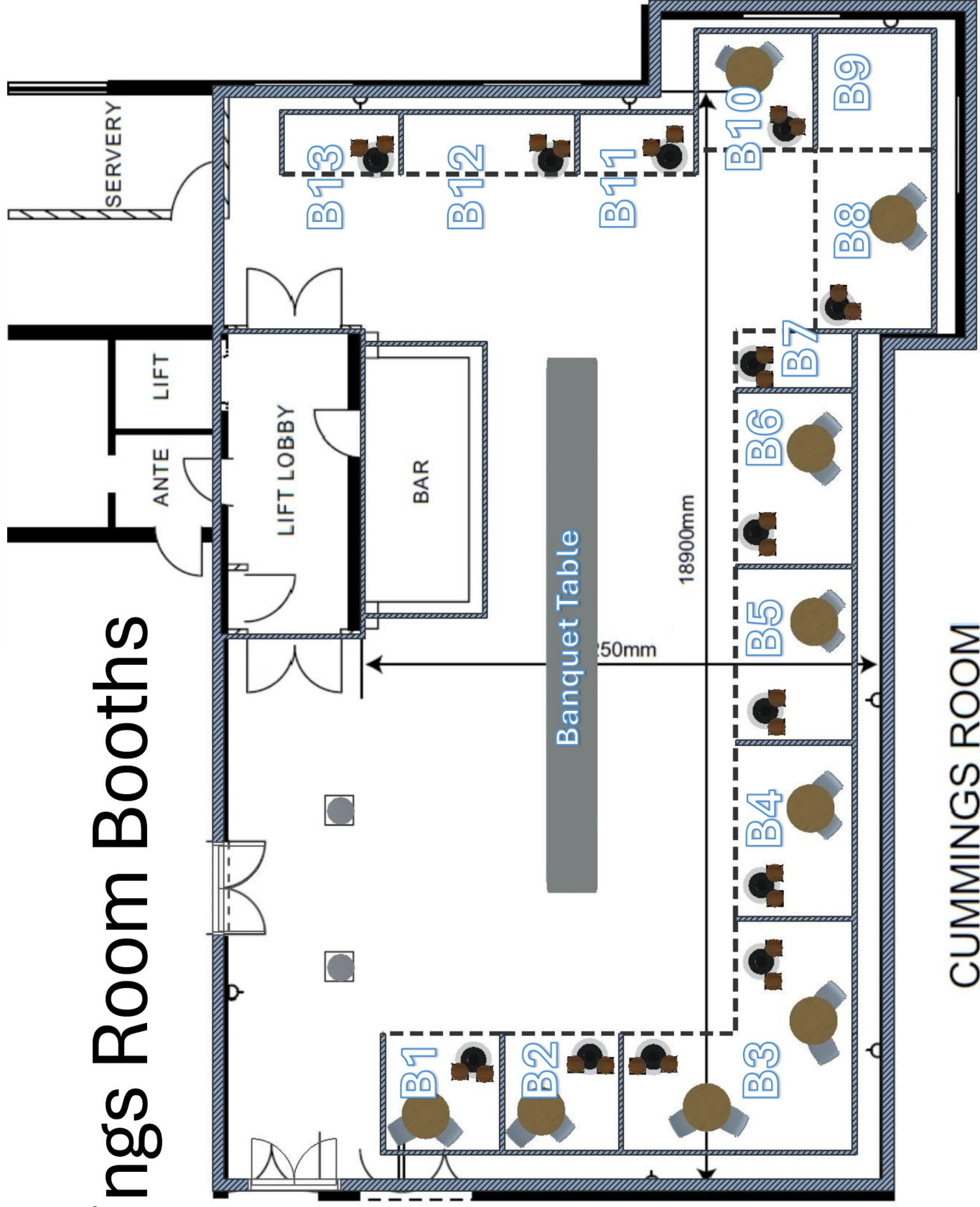

# Sponsorship Packages

## SBS 2024

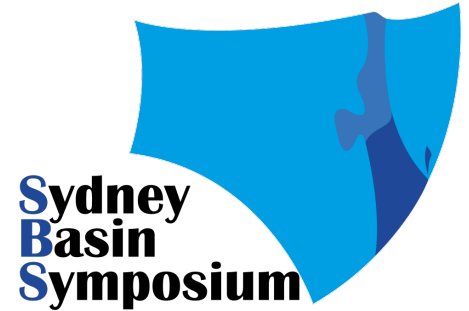

| Package                   | Number    | Cost (excl GST) | Inclusions   |
|---------------------------|-----------|-----------------|--|
| <b>Diamond</b>            | 2         | \$15,000        | <p>Two options available:</p> <ol style="list-style-type: none"> <li>1. Location B3 (12 m2 booth)</li> <li>2. Location B8 and B9 (10m2 booth)*</li> </ol> <p>Options include 5 x 2 day delegate registrations incl dinner</p> <p>Major Sponsor Recognition<br/>All advertising material (as provided by sponsor) including signage at venue<br/>Satchel insert</p> |
| <b>Corundum</b>           | 3         | \$10,000        | <p>Location B4, B5, B6, B8<br/>1 x large standard booth (2x3m booth)<br/>3 x 2 day delegate registrations incl dinner</p> <p>Naming rights for morning or afternoon session<br/>Advertising on marketing material<br/>Satchel insert</p>   |
| <b>Topaz</b>              | 4         | \$5,000         | <p>Location B1, B2, B9, B10<br/>1 x standard booth (2x2m booth)<br/>2 x 2 day delegate registrations incl dinner</p> <p>Advertising on marketing material<br/>Satchel insert</p>   |
| <b>Quartz</b>             | 4         | \$2,500         | <p>Location B7, B11, B13 (1 x 2m booth)<br/>Location B12 (1 x 3m booth)<br/>1 x 2 day delegate registration incl dinner</p> <p>Advertising on marketing material<br/>Satchel insert</p>  |
| <b>Orthoclase</b>         | Unlimited | \$1,000         | <p>Advertising on marketing material<br/>Satchel insert</p>  |
| <b>Dinner Sponsorship</b> | 1         | \$15,000        | <p>Naming rights<br/>1 x standard booth (2x2m)<br/>5 x 2 day delegate registrations incl dinner</p> <p>Advertising on marketing material<br/>Satchel insert</p>  |
| <b>Networking</b>         | 1         | \$5,000         | <p>Naming rights for Networking Event<br/>Advertising on marketing material</p>  |

\*Unless Booths B8 and B9 sold separately

# Location and Accommodation Information

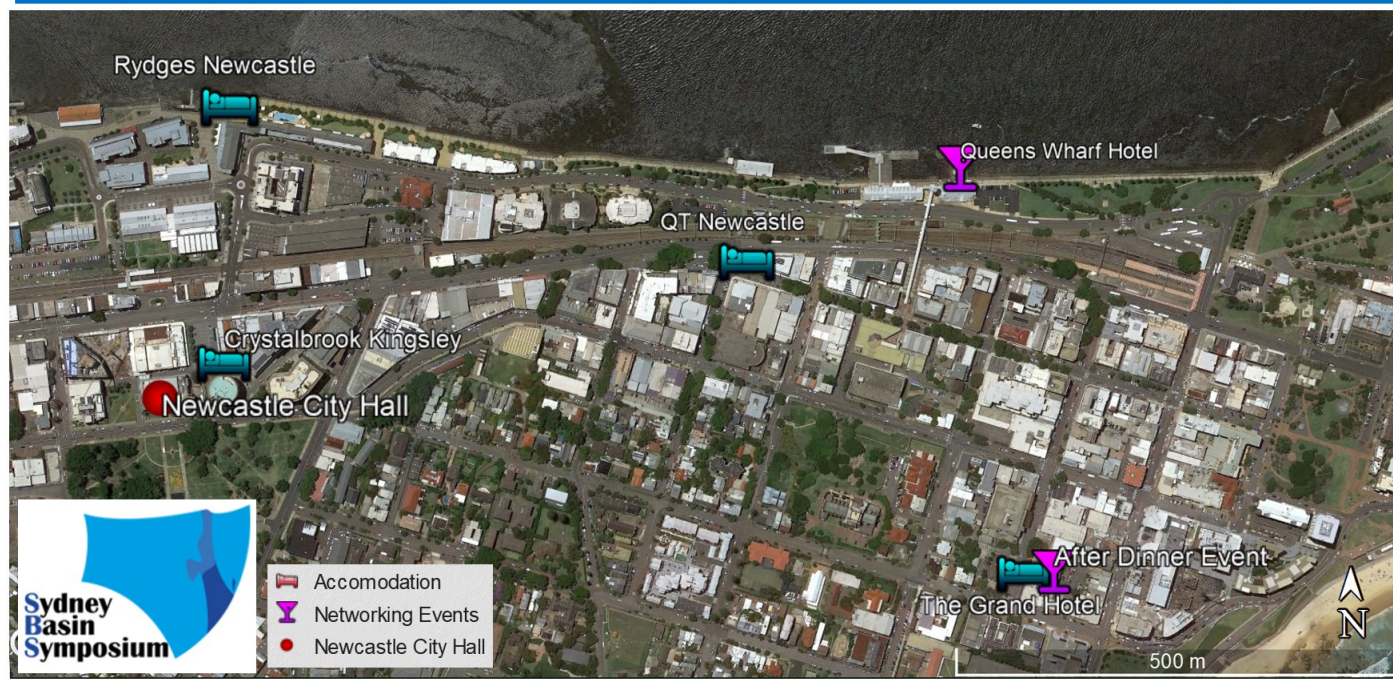
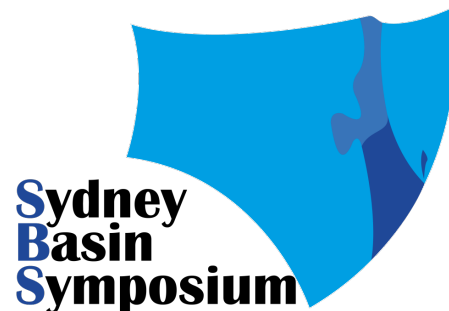

## Accommodation

We have sourced corporate rates with some providers. Please mention the Sydney Basin Symposium when booking with these providers and corporate rates may be applied. Availability is limited, so first in best dressed!

### The Grand

The Grand will offer a flat rate of \$140 per night (midweek) for symposium attendees. To book a room, call Lucas 02 4049 3686

### Rydges

Rydges will offer a 10% discount on their best available rate. Please use the link below.  
<https://www.rydges.com/private-page/sydney-basin-symposium/>

### QT

QT will offer special rates to attendees. Use the link <https://www.qthotels.com/newcastle/> and follow the instructions below.

1. Select your dates
2. click BOOK
3. Click on "I HAVE A CODE"
4. In the "CORPORATE ID" field enter your **corporate ID: 42SBS**
5. Click "CHECK ROOMS"
6. Your special rates will appear on the rates screen

### Crystalbrook

The Crystalbrook collection offers 10% off the best available rate of the day, at the time of booking. The offer is Crystalbrook CROWD. The Roundhouse Breakfast opens daily from 6:30am. A \$10 discount is offered to attendees staying at the hotel.



# Field Trip

## Newcastle Coastal Geotrail

## Sydney Basin Symposium

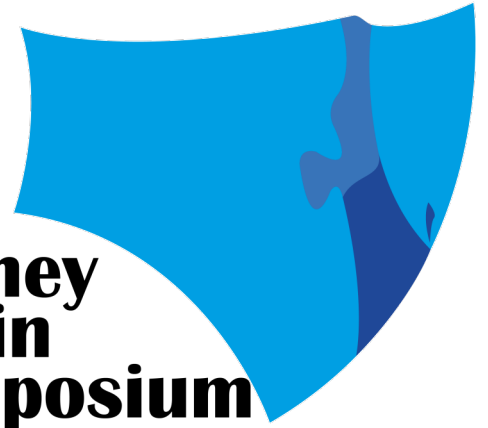

Join us on a wonderful exploration of Newcastle's amazing coastline led by our expert in all things Geotrail Dr Ron Boyd. A bus will transport us from one outcrop to the next as well as some exploration along the shoreline as we make our way along the Geotrail and learn about erupting volcanoes, ancient life and layers of time all displayed for us in the rock record along Newcastle's pristine beaches. At the end of our journey through time sit back, relax and enjoy the views and a delicious lunch at Merewether Surf House.

### Newcastle Coastal Geotrail - our dynamic coast

Around 255 million years ago, in the Permian Period, the climate and landscape around Newcastle were very different to those today. Wide rivers flowed across a cold and thickly forested landscape, depositing sediments over vast floodplains and swamps. From time to time, distant volcanic eruptions blanketed the region with ash. The layers of sediment and ash were later compacted and gently folded, to produce the undulating layers we now see in the cliffs around Newcastle. This sequence is called the Newcastle Coal Measures and coal seams can be traced between cliffs and headlands from Nobbys Head to Merewether Beach.

#### A changing geography

Back in the Permian, Australia was closer to the South Pole. Earth's tectonic plates were colliding along eastern Australia, resulting in volcanoes and high mountain ranges developing to the north of what is now Newcastle, and the broad Sydney Basin forming to the south and west. Between 84 and 52 million years ago, Australia separated from the continent of Zealandia (including New Zealand and Lord Howe Rise), creating the current coastline and injecting volcanic dykes that are still visible in cliffs and rock platforms. Over just the last 120 000 years the sea level has fluctuated more than 100 m, resulting in migration of the shoreline up to 25 km east and 30 km west of its current position!

#### The geotrail

Newcastle Coastal Geotrail largely follows scenic Bathers Way and is a walk of about 10 km one way. You can also drive to stops, which are mostly accessible from nearby car parks, although parking restrictions apply. Public buses service Nobbys Beach, Merewether Beach and coastal areas in between.

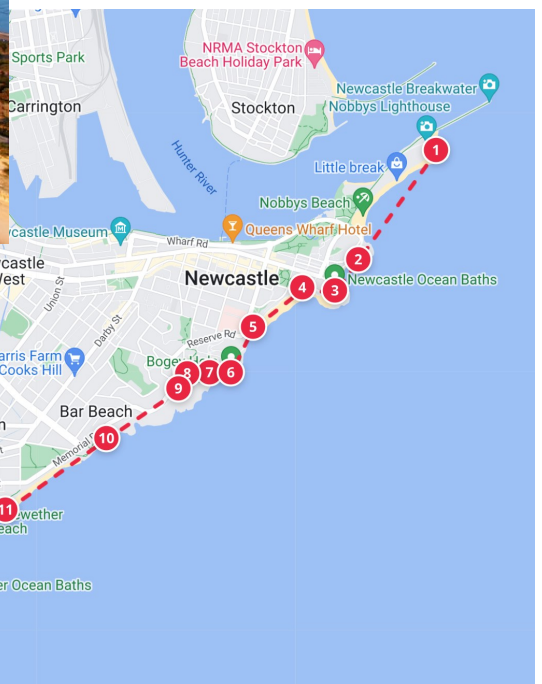
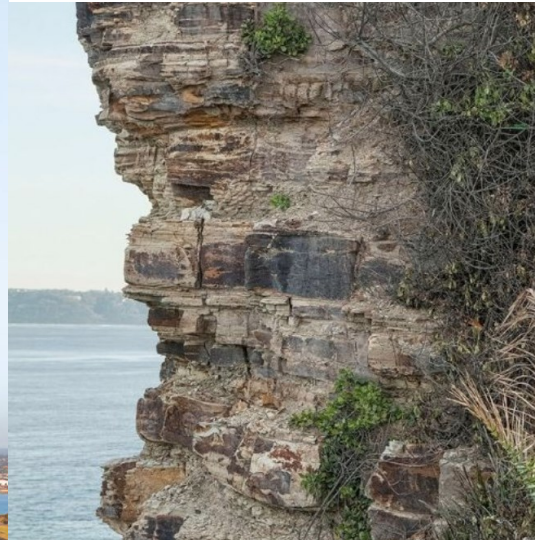

Southwesterly view of Newcastle coastline, with Nobbys Beach (foreground) and the Hunter River (right). Source: City of Newcastle.



## Newcastle Coastal Geotrail